

**EXPLANATORY PLAN TO ACCOMPANY
ROAD CLOSURE LAW CLOSING A
PORTION OF ROAD DEDICATED BY
PLAN NLT28 WITHIN DISTRICT LOT 8082,
RANGE 5, COAST DISTRICT,
GINGOLX VILLAGE LANDS.**

PURSUANT TO SECTION 98(1)(a) OF THE NISGA'A LAND TITLE ACT.

BCGS 1031.091

THE INTENDED PLOT SIZE OF THIS PLAN IS 432mm IN WIDTH BY 280mm IN HEIGHT (B SIZE) WHEN PLOTTED AT A SCALE OF 1:300



ALL DISTANCES ARE HORIZONTAL AT GROUND LEVEL AND ARE SHOWN IN METRES AND DECIMALS THEREOF, UNLESS OTHERWISE INDICATED.

LEGEND

BEARINGS ARE GRID BEARINGS DERIVED FROM PLAN NLT28.

THIS PLAN WAS COMPLETED AND CHECKED, AND THE CHECKLIST FILED UNDER #186654, ON THE 11th DAY OF MAY, 2016 AND IS HEREBY CERTIFIED CORRECT IN ACCORDANCE WITH NISGA'A LAND TITLE OFFICE RECORDS.

Todd Basky

TODD E. BASKY, BCLS 899

THIS PLAN LIES WITHIN THE REGIONAL DISTRICT OF KITIMAT - STIKINE

PLAN NLT 40

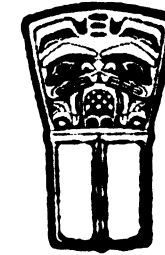
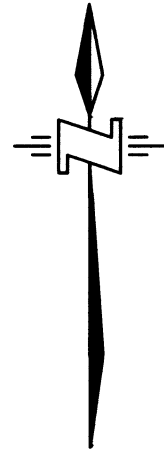

**NISGA'A
LAND
TITLE
OFFICE**

DEPOSITED IN THE NISGA'A LAND TITLE OFFICE
IN GITLAXT'AAMIKS, B.C.
THIS 24 DAY OF March, 2019.

Diane Craig
REGISTRAR

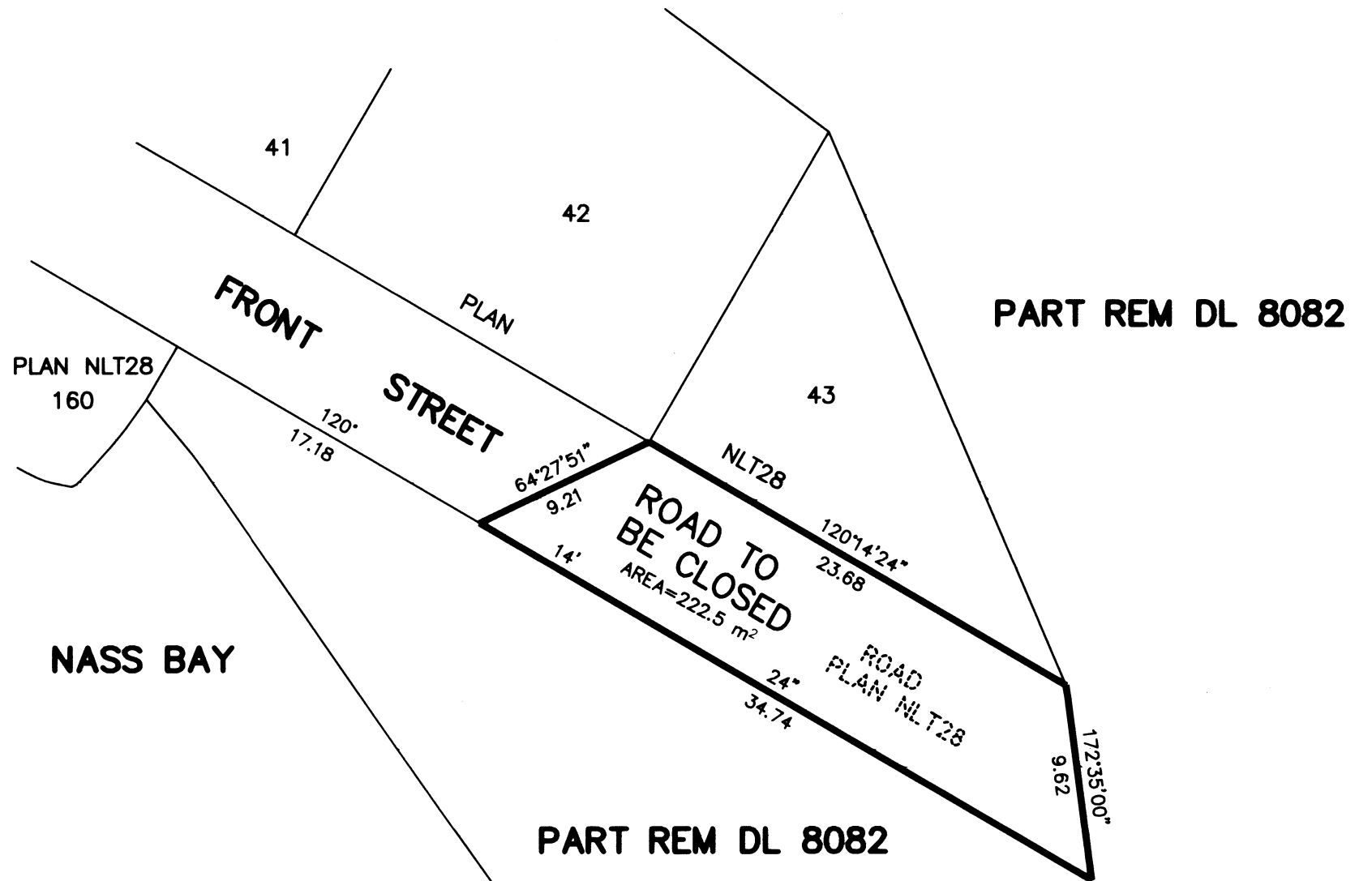

McELHANNEY ASSOCIATES
LAND SURVEYING LTD.
1-5008 POHLE AVENUE
TERRACE, B.C. V8G 4S8
FILE: 2321-44929-RC

ORIGINAL